

ISO1004R Contact Grip Replacement

P2746 Grip, HR, Contact, 1.5 ID, Pair

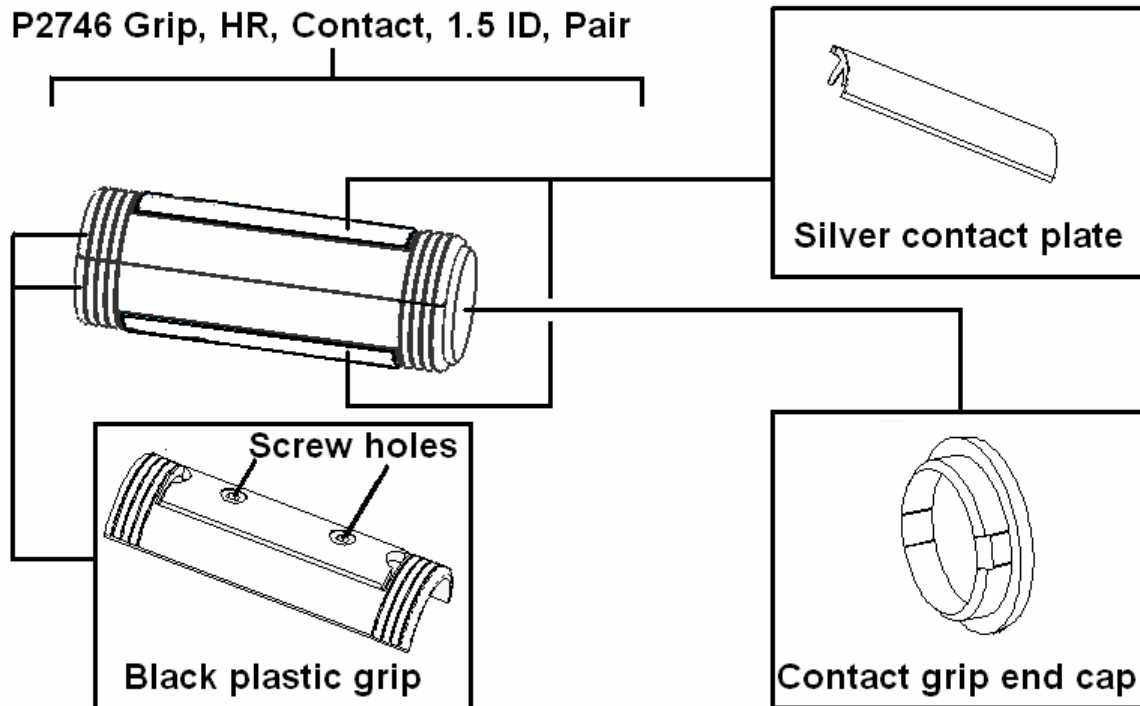

1. Insert the head of a small flathead screwdriver between the black plastic grip and contact grip end cap. Pry the end cap off and set aside.
2. Insert the head of the screwdriver under the corner of each silver plate and pry away from the black plastic grip. **Note: There are cables connected to each plate.**
3. Disconnect the contact grip cable from each silver contact plate. **Do not let the cables fall inside the handlebars.**
4. Using a small Philips screwdriver, remove the two screws that run through the center of each black plastic grip. **Do not lose the nuts that are on the opposite side of the black plastic grip as the screw heads.**
5. Remove the black plastic grips.
6. Position new black plastic grips and reinstall the screws and nuts in each. **Be careful not to over-tighten the screws as this will cause the black plastic grip to break.**
7. Reconnect the contact grip cable to each silver contact plate.
8. Insert silver plate back into the channel in the black plastic grip. Make sure not to pinch the cables under the silver contact plate.
9. Install contact grip end cap.
10. Test the unit in different programs to verify operation. **Do not use the Heart Rate program as it requires the use of a wireless chest strap.**